

PROJECT NO. 33
 CLAY COUNTY DITCH NO. 50 - IMPROVEMENTS
 1996 ASSESSMENT OF BENEFITS
 (ADOPTED 4/22/96)

RATE

- \$40 PER ACRE
- \$20 PER ACRE
- CITY OF MOORHEAD
- CITY OF DILWORTH

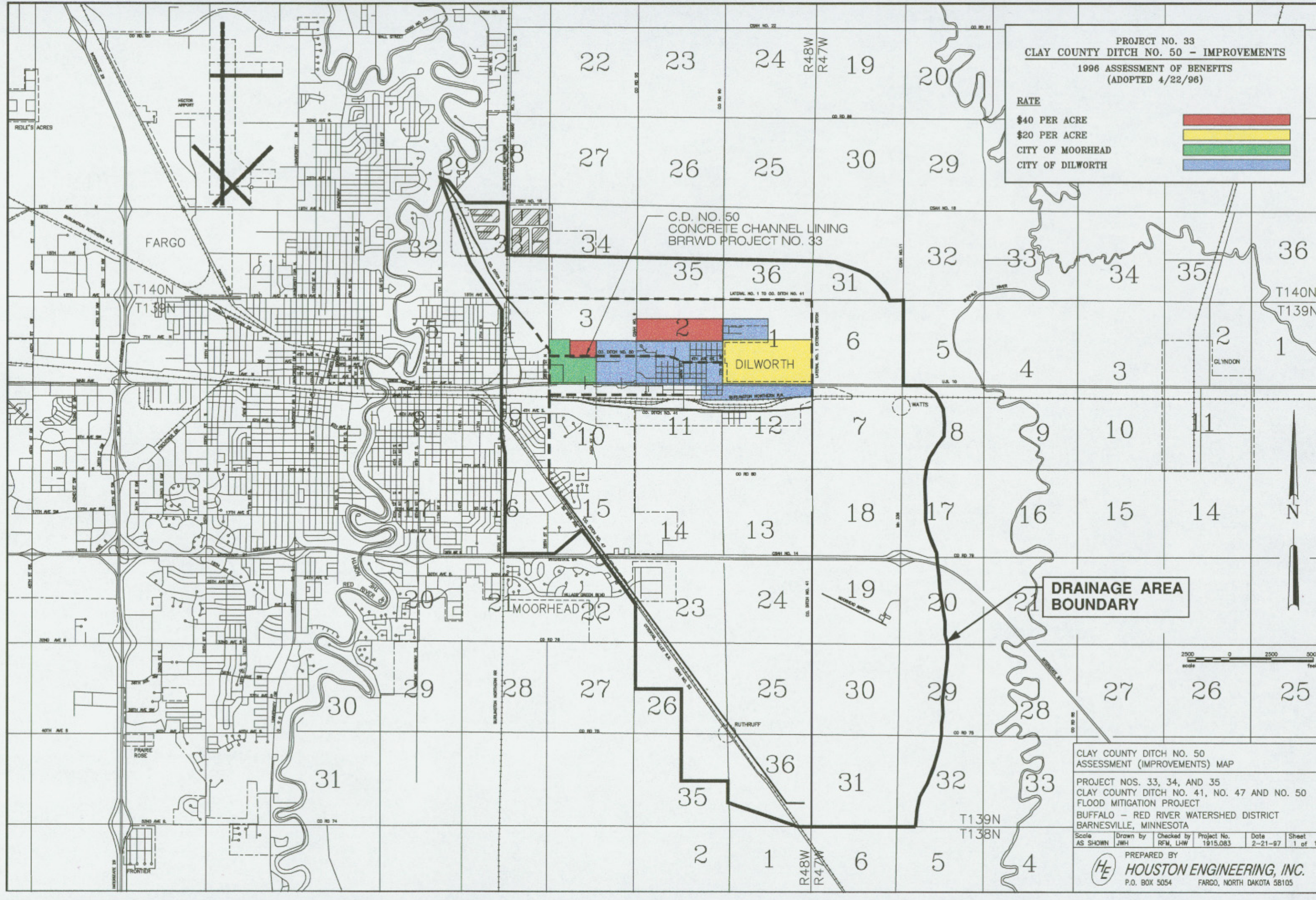

CLAY COUNTY DITCH NO. 50
 ASSESSMENT (IMPROVEMENTS) MAP

PROJECT NOS. 33, 34, AND 35
 CLAY COUNTY DITCH NO. 41, NO. 47 AND NO. 50
 FLOOD MITIGATION PROJECT
 BUFFALO - RED RIVER WATERSHED DISTRICT
 BARNESVILLE, MINNESOTA

Scale AS SHOWN	Drawn by JWH	Checked by RFM, LHW	Project No. 1915.083	Date 2-21-97	Sheet 1 of 1
----------------	--------------	---------------------	----------------------	--------------	--------------

PREPARED BY
 HOUSTON ENGINEERING, INC.
 P.O. BOX 5054 FARGO, NORTH DAKOTA 58105